

### CROSS-SECTION

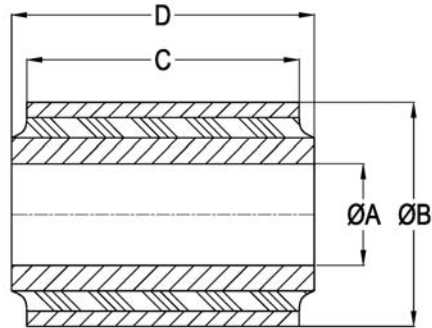

### FRONT-VIEW

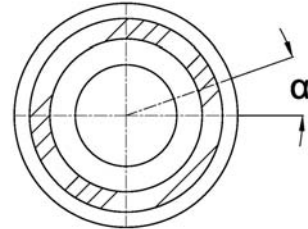

Type	Dimensions				Loads			
					Torsion		Radial	
	A (mm)	B (mm)	C (mm)	D (mm)	Nm/Rad	+/-α	N/mm	kN
10-UB-32x22x8	8	22	29	32	9	18.1	1167	0.65
10-UB-21x20x8	8	20	14	21	6.2	12.3	509	0.22
10-UB-28x29x12	12	29	25	28	29.6	14.6	2211	1.24
10-UB-24x26x12	12	26	20	24	31.0	12.4	1346	0.89
10-UB-48x27x14	14	27	40	48	-	-	-	-
10-UB-28x30x14	14	30	25	28	46.2	13.0	5802	2.50
10-UB-36x34x18	18	34	32	36	96.0	14.0	8490	4.34
10-UB-41x43x19	19	43	38	41	119.0	14.0	4074	3.00
10-UB-62x38x19	19	38	57	62	220.0	12.0	21900	11.0
10-UB-38x38x20	20	38	35	38	150.0	12.0	8605	4.59
10-UB-63x45x20	20	45	60	63	-	-	-	-
10-UB-42x46x20	20	46	35	42	206.0	14.0	7391	6.00
10-UB-34x50x20	20	50	30	34	-	-	-	-
10-UB-68x50x25	25	50	65	68	-	-	-	-
10-UB-68x60x30	30	60	60	68	-	-	-	-
10-UB-111x58x35	35	58	102	111	1036.0	13.5	17544	20.00