

B-UNF-Mounts

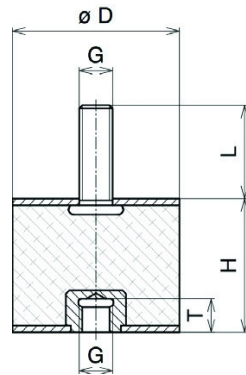

| Part Number | Dia. x Height mm (Inch) (D) x (H) | Thread (G) | Length mm (Inch) (L) | Thickness mm (Inch) (S) | Quality NR ShoreA Duro | Compression | | | | Shear | | | |
|-------------|--|---------------|-------------------------------|----------------------------------|-------------------------------------|------------------|-----|-------------------|--------|------------------|-----|-------------------|--------|
| | | | | | | Max. Static Load | | Spring Rate Ks | | Max. Static Load | | Spring Rate Ks | |
| | | | | | | N | lbs | N/mm | lbs/in | N | lbs | N/mm | lbs/in |
| 9764HF | 8 x 8 (.31) x (.31) | UNC4-40 | 6 (.24) | 1 (.04) | 43 | 23 | 5 | 53 | 300 | 8 | 2 | 10 | 57 |
| 9764BF | | | | | 57 | 43 | 10 | 98 | 554 | 15 | 3 | 19 | 105 |
| 9764LU | | | | | 68 | 69 | 16 | 159 | 899 | 24 | 5 | 30 | 170 |
| 9797HF | 8 x 8 (.31) x (.31) | UNC6-32 | 6 (.24) | 1 (.04) | 43 | 18 | 4 | 23 | 130 | 6 | 1 | 5 | 28 |
| 9797BF | | | | | 57 | 33 | 7 | 43 | 240 | 11 | 2 | 9 | 52 |
| 9797LU | | | | | 68 | 54 | 12 | 69 | 390 | 18 | 4 | 15 | 85 |
| 9712HF | 9.7 x 6.4 (.38) x (.25) | UNC8-32 | 10 (.39) | 1 (.04) | 43 | 16 | 4 | 15 | 85 | 5 | 1 | 4 | 23 |
| 9712BF | | | | | 57 | 30 | 7 | 28 | 157 | 9 | 2 | 7 | 42 |
| 9712LF | | | | | 68 | 48 | 11 | 45 | 254 | 15 | 3 | 12 | 68 |
| 1613H6F13 | 15.8 x 12.7 (.62) x (.5) | UNF1/4-28 | 12.7 (.5) | 1.5 (.06) | 43 | 71 | 16 | 115 | 650 | 24 | 5 | 19 | 107 |
| 1613B6F13 | | | | | 57 | 131 | 30 | 213 | 1202 | 44 | 10 | 35 | 199 |
| 1613L6F13 | | | | | 68 | 213 | 48 | 345 | 1950 | 72 | 16 | 57 | 322 |
| 1616H6F13 | 15.8 x 15.8 (.62) x (.62) | UNF1/4-28 | 12.7 (.5) | 1.5 (.06) | 43 | 56 | 13 | 61 | 345 | 19 | 4 | 12 | 68 |
| 1616B6F13 | | | | | 57 | 104 | 23 | 113 | 638 | 35 | 8 | 22 | 125 |
| 1616L6F13 | | | | | 68 | 168 | 38 | 183 | 1034 | 57 | 13 | 36 | 203 |
| 2015HF16 | 20 x 15 (.79) x (.59) | UNF10-32 | 10 (.39) | 2 (.08) | 43 | 120 | 27 | 172 | 972 | 40 | 9 | 26 | 147 |
| 2015BF16 | | | | | 57 | 222 | 50 | 318 | 1798 | 74 | 17 | 48 | 272 |
| 2015LF16 | | | | | 68 | 360 | 81 | 516 | 2916 | 120 | 27 | 78 | 441 |
| 2020HF10 | 20 x 20 (.79) x (.79) | UNF10-32 | 10 (.39) | 2 (.08) | 43 | 71 | 16 | 86 | 486 | 29 | 7 | 15 | 85 |
| 2020BF10 | | | | | 57 | 131 | 30 | 159 | 899 | 54 | 12 | 28 | 157 |
| 2020LF10 | | | | | 68 | 213 | 48 | 258 | 1458 | 87 | 20 | 45 | 254 |
| 2025HF10 | 20 x 25 (.79) x (.98) | UNF10-32 | 10 (.39) | 2 (.08) | 43 | 74 | 17 | 44 | 249 | 25 | 6 | 11 | 62 |
| 2025BF10 | | | | | 57 | 137 | 31 | 81 | 460 | 46 | 10 | 20 | 115 |
| 2025LF10 | | | | | 68 | 222 | 50 | 132 | 746 | 75 | 17 | 33 | 186 |
| 2030HF10 | 20 x 30 (.79) x (1.18) | UNF10-32 | 10 (.39) | 2 (.08) | 43 | 69 | 16 | 31 | 175 | 23 | 5 | 8 | 45 |
| 2030BF10 | | | | | 57 | 128 | 29 | 57 | 324 | 43 | 10 | 15 | 84 |
| 2030LF10 | | | | | 68 | 207 | 47 | 93 | 526 | 69 | 16 | 24 | 136 |
| 2513HF10 | 25.4 x 12.7 (1) x (.5) | UNF10-32 | 10 (.39) | 2 (.08) | 43 | 217 | 49 | 298 | 1684 | 72 | 31 | 38 | 215 |
| 2513BF10 | | | | | 57 | 401 | 90 | 551 | 3116 | 133 | 30 | 70 | 397 |
| 2513LF10 | | | | | 68 | 651 | 146 | 894 | 5052 | 216 | 49 | 114 | 644 |
| 2515HF10 | 25.4 x 15.7 (1) x (.62) | UNF10-32 | 10 (.39) | 2 (.08) | 43 | 178 | 40 | 192 | 1085 | 59 | 13 | 59 | 333 |
| 2515BF10 | | | | | 57 | 329 | 74 | 355 | 2007 | 109 | 25 | 109 | 617 |
| 2515LF10 | | | | | 68 | 534 | 120 | 576 | 3255 | 177 | 40 | 177 | 1000 |

B-UNF-Mounts

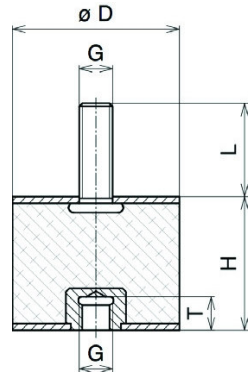

| Part Number | Dia. x Height mm (Inch) (D) x (H) | Thread (G) | Length mm (Inch) (L) | Thickness mm (Inch) (S) | Quality NR ShoreA Duro | Compression | | | | Shear | | | |
|-------------|---|---------------|----------------------------|-------------------------------|-------------------------------|------------------|------|----------------|--------|------------------|-----|----------------|--------|
| | | | | | | Max. Static Load | | Spring Rate Ks | | Max. Static Load | | Spring Rate Ks | |
| | | | | | | N | lbs | N/mm | lbs/in | N | lbs | N/mm | lbs/in |
| 2519HF10 | 25.4 x 19.1 (1) x (.75) | UNF10-32 | 10 (.39) | 2 (.08) | 43 | 142 | 32 | 107 | 605 | 47 | 11 | 21 | 119 |
| 57 | | | | | 263 | 59 | 198 | 1119 | 87 | 20 | 39 | 220 | |
| 68 | | | | | 426 | 96 | 321 | 1814 | 141 | 32 | 63 | 356 | |
| 2525HF10 | 25.4 x 25.4 (1) x (1) | UNF10-32 | 10 (.39) | 2 (.08) | 43 | 120 | 27 | 62 | 350 | 40 | 9 | 15 | 85 |
| 57 | | | | | 222 | 50 | 115 | 648 | 74 | 17 | 28 | 157 | |
| 68 | | | | | 360 | 81 | 186 | 1051 | 120 | 27 | 45 | 254 | |
| 5020HF28 | 50 x 20 (1.97) x (.79) | UNC3/8-16 | 25 (.98) | 2 (.08) | 43 | 1276 | 287 | 1271 | 7183 | 425 | 96 | 112 | 633 |
| 57 | | | | | 2361 | 531 | 2351 | 13288 | 786 | 177 | 207 | 1171 | |
| 68 | | | | | 3828 | 861 | 3813 | 21548 | 1275 | 287 | 336 | 1899 | |
| 5025HF28 | 50 x 25 (1.97) x (.98) | UNF3/8-24 | 25 (.98) | 2 (.08) | 43 | 848 | 191 | 564 | 3187 | 283 | 64 | 75 | 424 |
| 57 | | | | | 1569 | 353 | 1043 | 5896 | 524 | 118 | 139 | 784 | |
| 68 | | | | | 2544 | 572 | 1692 | 9562 | 849 | 191 | 225 | 1272 | |
| 5030HF28 | 50 x 30 (1.97) x (1.18) | UNF3/8-24 | 25 (.98) | 2 (.08) | 43 | 677 | 152 | 338 | 1910 | 226 | 47 | 56 | 316 |
| 57 | | | | | 1252 | 282 | 625 | 3534 | 418 | 94 | 104 | 585 | |
| 68 | | | | | 2031 | 457 | 1014 | 5730 | 678 | 152 | 168 | 949 | |
| 5035HF28 | 50 x 35 (1.97) x (1.38) | UNF3/8-24 | 25 (.98) | 2 (.08) | 43 | 588 | 132 | 235 | 1328 | 196 | 31 | 45 | 254 |
| 57 | | | | | 1088 | 245 | 435 | 2457 | 363 | 82 | 83 | 470 | |
| 68 | | | | | 1764 | 397 | 705 | 3984 | 588 | 132 | 135 | 763 | |
| 5040HF28 | 50 x 40 (1.97) x (1.57) | UNF3/8-24 | 25 (.98) | 2 (.08) | 43 | 534 | 120 | 178 | 1006 | 178 | 40 | 37 | 209 |
| 57 | | | | | 988 | 222 | 329 | 1861 | 329 | 74 | 68 | 387 | |
| 68 | | | | | 1602 | 360 | 534 | 3018 | 534 | 120 | 111 | 627 | |
| 5045HF28 | 50 x 45 (1.97) x (1.77) | UNF3/8-24 | 25 (.98) | 2 (.08) | 43 | 499 | 112 | 142 | 802 | 166 | 37 | 32 | 181 |
| 57 | | | | | 923 | 208 | 263 | 1485 | 307 | 69 | 59 | 335 | |
| 68 | | | | | 1497 | 337 | 426 | 2407 | 498 | 112 | 96 | 543 | |
| 5050GF28 | 50 x 50 (1.97) x (1.97) | UNF3/8-24 | 28 (1.10) | 2 (.08) | 43 | 474 | 107 | 118 | 667 | 158 | 36 | 28 | 158 |
| 57 | | | | | 877 | 197 | 218 | 1234 | 292 | 66 | 52 | 293 | |
| 68 | | | | | 1422 | 320 | 354 | 2001 | 474 | 107 | 84 | 475 | |
| 5075GF28 | 50 x 75 (1.97) x (2.95) | UNF3/8-24 | 28 (1.10) | 3 (.12) | 43 | 413 | 93 | 64 | 362 | 138 | 31 | 17 | 96 |
| 57 | | | | | 764 | 172 | 118 | 669 | 255 | 57 | 31 | 178 | |
| 68 | | | | | 1239 | 279 | 192 | 1085 | 414 | 93 | 51 | 288 | |

B-UNF-Mounts

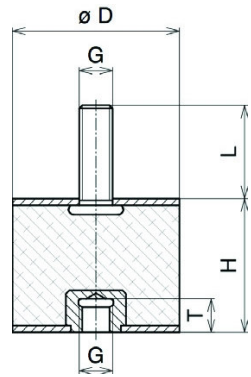

| Part Number | Dia. x Height mm (Inch) (D) x (H) | Thread (G) | Length mm (Inch) (L) | Thickness mm (Inch) (S) | Quality NR ShoreA Duro | Compression | | | | Shear | | | |
|-------------|--|---------------|-------------------------------|----------------------------------|-------------------------------------|------------------|-----|-------------------|--------|------------------|-----|-------------------|--------|
| | | | | | | Max. Static Load | | Spring Rate Ks | | Max. Static Load | | Spring Rate Ks | |
| | | | | | | N | lbs | N/mm | lbs/in | N | lbs | N/mm | lbs/in |
| 5020H13F25 | 50 x 20 (1.97) x (.79) | UNC1/2-20 | 25 (.98) | 3 (.12) | 43 | 1276 | 287 | 1271 | 7183 | 425 | 96 | 112 | 633 |
| 5020B13F25 | | | | | 57 | 2361 | 531 | 2351 | 13288 | 786 | 177 | 207 | 1171 |
| 5020L13F25 | | | | | 68 | 3828 | 861 | 3813 | 21548 | 1275 | 287 | 336 | 1899 |
| 5025H13F25 | 50 x 25 (1.97) x (.98) | UNC1/2-20 | 25 (.98) | 3 (.12) | 43 | 848 | 191 | 564 | 3187 | 283 | 64 | 75 | 424 |
| 5025B13F25 | | | | | 57 | 1569 | 353 | 1043 | 5896 | 524 | 118 | 139 | 784 |
| 5025L13F25 | | | | | 68 | 2544 | 572 | 1692 | 9562 | 849 | 191 | 225 | 1272 |
| 5030H13F25 | 50 x 30 (1.97) x (1.18) | UNC1/2-20 | 25 (.98) | 3 (.12) | 43 | 677 | 152 | 338 | 1910 | 226 | 47 | 56 | 316 |
| 5030B13F25 | | | | | 57 | 1252 | 282 | 625 | 3534 | 418 | 94 | 104 | 585 |
| 5030L13F25 | | | | | 68 | 2031 | 457 | 1014 | 5730 | 678 | 152 | 168 | 949 |
| 5035H13F25 | 50 x 35 (1.97) x (1.38) | UNC1/2-20 | 25 (.98) | 3 (.12) | 43 | 588 | 132 | 235 | 1328 | 196 | 31 | 45 | 254 |
| 5035B13F25 | | | | | 57 | 1088 | 245 | 435 | 2457 | 363 | 82 | 83 | 470 |
| 5035L13F25 | | | | | 68 | 1764 | 397 | 705 | 3984 | 588 | 132 | 135 | 763 |
| 5040H13F25 | 50 x 40 (1.97) x (1.57) | UNC1/2-20 | 25 (.98) | 3 (.12) | 43 | 534 | 120 | 178 | 1006 | 178 | 40 | 37 | 209 |
| 5040B13F25 | | | | | 57 | 988 | 222 | 329 | 1861 | 329 | 74 | 68 | 387 |
| 5040L13F25 | | | | | 68 | 1602 | 360 | 534 | 3018 | 534 | 120 | 111 | 627 |
| 5045H13F25 | 50 x 45 (1.97) x (1.77) | UNC1/2-20 | 25 (.98) | 3 (.12) | 43 | 499 | 112 | 142 | 802 | 166 | 37 | 32 | 181 |
| 5045B13F25 | | | | | 57 | 923 | 208 | 263 | 1485 | 307 | 69 | 59 | 335 |
| 5045L13F25 | | | | | 68 | 1497 | 337 | 426 | 2407 | 498 | 112 | 96 | 543 |
| 5050H13F25 | 50 x 50 (1.97) x (1.97) | UNC1/2-20 | 25 (.98) | 3 (.12) | 43 | 474 | 107 | 118 | 667 | 158 | 36 | 28 | 158 |
| 5050B13F25 | | | | | 57 | 877 | 197 | 218 | 1234 | 292 | 66 | 52 | 293 |
| 5050L13F25 | | | | | 68 | 1422 | 320 | 354 | 2001 | 474 | 107 | 84 | 475 |
| 5075H13F25 | 50 x 75 (1.97) x (2.95) | UNC1/2-20 | 25 (.98) | 3 (.12) | 43 | 413 | 93 | 64 | 362 | 138 | 31 | 17 | 96 |
| 5075B13F25 | | | | | 57 | 764 | 172 | 118 | 669 | 255 | 57 | 31 | 178 |
| 5075L13F25 | | | | | 68 | 1239 | 279 | 192 | 1085 | 414 | 93 | 51 | 288 |
| | | | | | | | | | | | | | |
| | | | | | | | | | | | | | |
| | | | | | | | | | | | | | |

B-UNF-Mounts

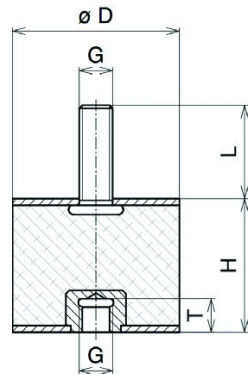

| Part Number | Dia. x Height mm (Inch) (D) x (H) | Thread (G) | Length mm (Inch) (L) | Thickness mm (Inch) (S) | Quality NR ShoreA Duro | Compression | | | | Shear | | | |
|-------------------------------------|---|---------------|----------------------------|-------------------------------|-------------------------------|----------------------|---------------------|----------------------|-------------------------|---------------------|-------------------|-------------------|---------------------|
| | | | | | | Max. Static Load | | Spring Rate Ks | | Max. Static Load | | Spring Rate Ks | |
| | | | | | | N | lbs | N/mm | lbs/in | N | lbs | N/mm | lbs/in |
| 7525HF38 7525BF38 7525LF38 | 75 x 25 (2.95) x (.98) | UNC1/2-20 | 38 (1.50) | 3 (.12) | 43 57 68 | 2783 5149 8349 | 626 1157 1877 | 1798 3326 5394 | 10161 18798 30483 | 928 1717 2784 | 209 386 626 | 163 302 489 | 921 1704 2763 |
| 7530HF38 7530BF38 7530LF38 | 75 x 30 (2.95) x (1.18) | UNC1/2-20 | 38 (1.50) | 3 (.12) | 43 57 68 | 2083 3854 6249 | 468 866 1405 | 1017 1881 3051 | 5747 10632 17242 | 694 1284 2082 | 156 289 468 | 123 228 369 | 695 1286 2085 |
| 7540HF38 7540BF38 7540LF38 | 75 x 40 (2.95) x (1.57) | UNC1/2-20 | 38 (1.50) | 3 (.12) | 43 57 68 | 1508 2790 4524 | 339 627 1017 | 495 916 1485 | 2797 5175 8392 | 503 931 1509 | 113 209 339 | 83 154 249 | 469 868 1407 |
| 7550HF38 7550BF38 7550LF38 | 75 x 50 (2.95) x (1.97) | UNC1/2-20 | 38 (1.50) | 3 (.12) | 43 57 68 | 1269 2348 3807 | 285 528 856 | 314 581 942 | 1774 3283 5323 | 429 794 1287 | 47 178 289 | 62 115 186 | 350 648 1051 |
| 7555HF38 7555BF38 7555LF38 | 75 x 55 (2.95) x (2.17) | UNC1/2-20 | 38 (1.50) | 3 (.12) | 43 57 68 | 1197 2214 3591 | 269 498 807 | 263 487 789 | 1486 2750 4459 | 399 738 1197 | 31 166 269 | 55 102 165 | 311 575 932 |
| 7560HF38 7560BF38 7560LF38 | 75 x 60 (2.95) x (2.36) | UNC1/2-20 | 38 (1.50) | 3 (.12) | 43 57 68 | 1110 2054 3330 | 250 462 749 | 206 381 618 | 1164 2154 3492 | 370 685 1110 | 83 154 250 | 47 87 141 | 266 491 797 |
| 7575HF38 7575BF38 7575LF38 | 75 x 75 (2.95) x (2.95) | UNC1/2-20 | 38 (1.50) | 3 (.12) | 43 57 68 | 1035 1915 3105 | 233 430 698 | 158 292 474 | 893 1652 2679 | 345 638 1035 | 78 143 233 | 39 72 117 | 220 408 661 |
| 75100HF38 75100BF38 75100LF38 | 75 x 100 (2.95) x (3.94) | UNC1/2-20 | 38 (1.50) | 3 (.12) | 43 57 68 | 946 1750 2838 | 213 393 638 | 105 194 315 | 593 1098 1780 | 315 583 945 | 71 131 212 | 28 52 84 | 158 293 475 |
| 8050HF 8050BF 8050LF | 80 x 50 (3.15) x (1.97) | UNC1/2-20 | 38 (1.50) | 3 (.12) | 43 57 68 | 1492 2760 4476 | 335 621 1006 | 374 692 1122 | 2114 3910 6341 | 497 919 1491 | 112 207 335 | 70 130 210 | 396 732 1187 |
| 8057HF 8057BF 8057LF | 80 x 57 (3.15) x (2.24) | UNC1/2-20 | 38 (1.50) | 3 (.12) | 43 57 68 | 1373 2540 4119 | 309 571 926 | 288 533 864 | 1628 3011 4883 | 458 847 1374 | 103 190 309 | 60 111 180 | 339 627 1017 |
| 8075HF 8075BF 8075LF | 80 x 75 (3.15) x (2.95) | UNC1/2-20 | 38 (1.50) | 3 (.12) | 43 57 68 | 1203 2226 3609 | 270 500 811 | 183 339 549 | 1034 1913 3103 | 401 742 1203 | 90 167 270 | 44 81 132 | 249 460 746 |